



X1-BT Operation Instruction

Thank you for purchasing X1-BT. X1-BT is a replacement battery for retention of the contents of calendar and BIOS settings of X1 series.
Make sure that the delivered unit conforms to your requirement, and also check for any missing or damaged parts.
Before using the product, carefully read this manual and X1 Series Hardware Specifications manual and make sure you understand them.

Product Configuration

Coin-type lithium primary cell	1 pc.
Operation Instruction (This manual)	1 copy
Sticker for time to replace a battery	1 copy

Notes on Safe Usage

In this manual, you will find various notes categorized under the following levels with the signal words "DANGER," and "CAUTION."

DANGER	Indicates an imminently hazardous situation which, if not avoided, will result in death or serious injury.
CAUTION	Indicates a potentially hazardous situation which, if not avoided, may result in minor or moderate injury and could cause property damage.

Note that there is a possibility that the item listed with **CAUTION** may have serious ramifications.

DANGER

- Never disassemble, recharge, deform by pressure, short-circuit, reverse the polarity of the battery, nor dispose of the lithium battery in fire. Failure to follow these conditions will lead to explosion or ignition.
- Never use a battery that is deformed, leaking, or shows any other signs of abnormality. Failure to follow these conditions will lead to explosion or ignition.

CAUTION

- Only experts are authorized to replace the battery.
- Be sure to discharge static electricity from your body before performing battery replacement.
- Rough handling of the battery may cause fire or chemical burns.
- Observe local and governmental regulations when disposing of waste batteries.
- Keep batteries out of reach of children. (If swallowed, immediately consult a doctor.)
- If a battery leaks or smells, note that the leaking battery electrolyte is flammable. Keep away from heat or flame.

Supported Types

X1121, X1151

How to Replace a Battery

Replace the battery with the unit's power turned off. Set the calendar after replacing the battery because the calendar data may result in loss of data. About the calendar setting procedure, refer to X1 Series Hardware Specifications manual.

1. Turn OFF power the X1 series unit.
2. Disconnect the power supply terminal block and all cables.
3. Remove the eight screws shown below.

X112 series

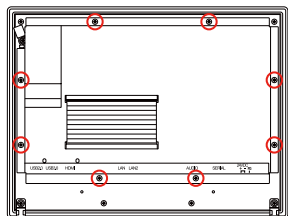

X115 series

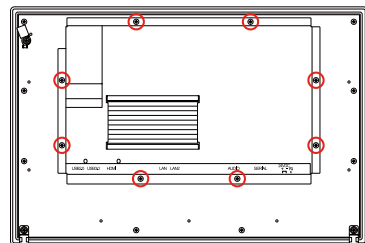

4. Remove the cover while tilting it towards you.

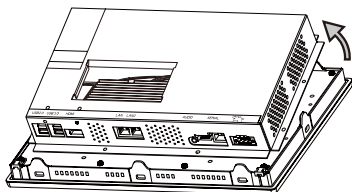

5. Pull the battery out of the battery holder and disconnect the battery connector.

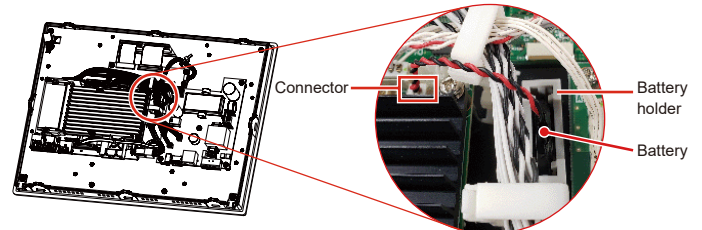

6. Insert the new battery connector into the board and insert the battery deep into the battery holder.

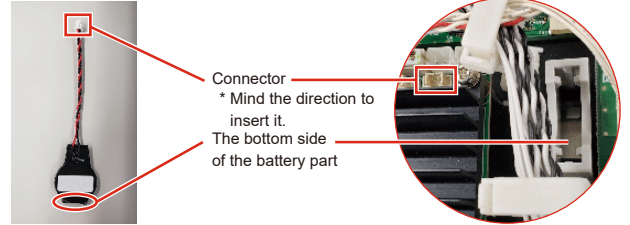

7. Put the cover on from the front side.
8. Install the eight screws removed in step 3. (5.75 ~ 6.2 lbf-in (0.65 ~ 0.7 N·m))
9. Remove the "Sticker for time to replace a battery" on the back of the unit. Attach a new sticker with the date in three years, which is the next recommended date for replacement.

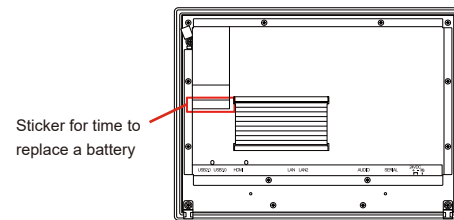

Notes on Transport

This product uses a battery that contains lithium metal. Transportation of batteries containing lithium must observe the relevant transport regulations. Shipping packing of the X1 series and the replacement battery complies with transport regulations. If the product is re-transported after unpacking, observe the IATA Dangerous Goods Regulations, the IMDG Code, and the relevant transport regulations of each country.

Notes on the Directive 2006/66/EC



- The above symbol mark is valid for countries in the European Union only.
- The above symbol mark is according to the Directive 2006/66/EC Article 20 Information for end-users and Annex II.
- The above symbol mark means that battery, at the end-of-life, should be disposed of separately from your household waste.
- If a chemical symbol is printed beneath the symbol shown above, this chemical symbol means that the battery contains a heavy metal at a certain concentration. This will be indicated as follows:
Hg: mercury (0.0005 %), Cd: cadmium (0.002 %), Pb: lead (0.004 %)
- In the European Union, there are separate collection systems for used batteries. Please dispose of batteries correctly at your local community waste collection/recycling centre.

About State of California, USA Regulations Concerning Perchlorate Best Management Practices (BMP)

X1-BT is the product affected by the above regulations concerning perchlorate BMP. Packages of the X1 series unit and replacement battery are labeled as indicated below.

Perchlorate Material - special handling may apply.
See www.dtsc.ca.gov/hazardouswaste/perchlorate/.

You need to mark as indicated above on your package etc. when exporting the product incorporating X1 series attached X1-BT to the state of California.

FE Hakko Electronics Co., Ltd.

890-1, Kamikashiwano-machi, Hakusan-shi, Ishikawa, 924-0035 Japan

TEL : +81-76-274-2144

FAX : +81-76-274-5136

URL www.monitouch.com